

THIS DRAWING IS UNPUBLISHED. RELEASED FOR PUBLICATION  
 © COPYRIGHT BY TYCO ELECTRONICS CORPORATION. ALL RIGHTS RESERVED.

LOC	DIST	REVISIONS					
CM	54	P	LTR	DESCRIPTION	DATE	DWN	APVD
		B		ECO-07-012890	22JUN07	KW	DB
		B1		REVISED PER ECO-09-023313	12OCT09	KK	AEG

- 1 MATERIAL: CONNECTOR - NYLON UL94V-0 (BLACK).  
 CONTACTS - 0.30[.012] THICK COPPER ALLOY  
 (BRIGHT-TIN LEAD 0.00203  
 [.000080] MIN THK FOR CONTACTS  
 644566-2 THRU 1-644566-2, MATTE  
 WHISKER MITIGATED TIN IN 0.00203 [.000080]  
 MIN THICKNESS OVER NICKEL UNDERPLATE  
 FOR 3-644566-2 THRU 4-644566-2)
- 2. CONTACTS ACCEPT 22 AWG WIRE WITH 2.41[.095] MAX  
 INSULATION DIAMETER.
- 3. CONTACTS MUST ACCEPT 1.14±0.03[.045±.001] SQUARE  
 POST AND REMAIN LOCKED IN POSITION.
- 4 IDENTIFICATION NUMBER FOR LAST CIRCUIT MAY  
 NOT APPEAR ON ALL ASSEMBLIES.
- 5. DIMENSIONS IN BRACKETS ARE IN INCHES.
- 6. HOUSING FEATURES ARE: CLOSED END WITHOUT  
 LOCKING RAMP AND WITH POLARIZING TAB.
- 7 OBSOLETE PARTS: OBSOLETE CIS STREAMLINING PER D.RENAUD/D.SINISI

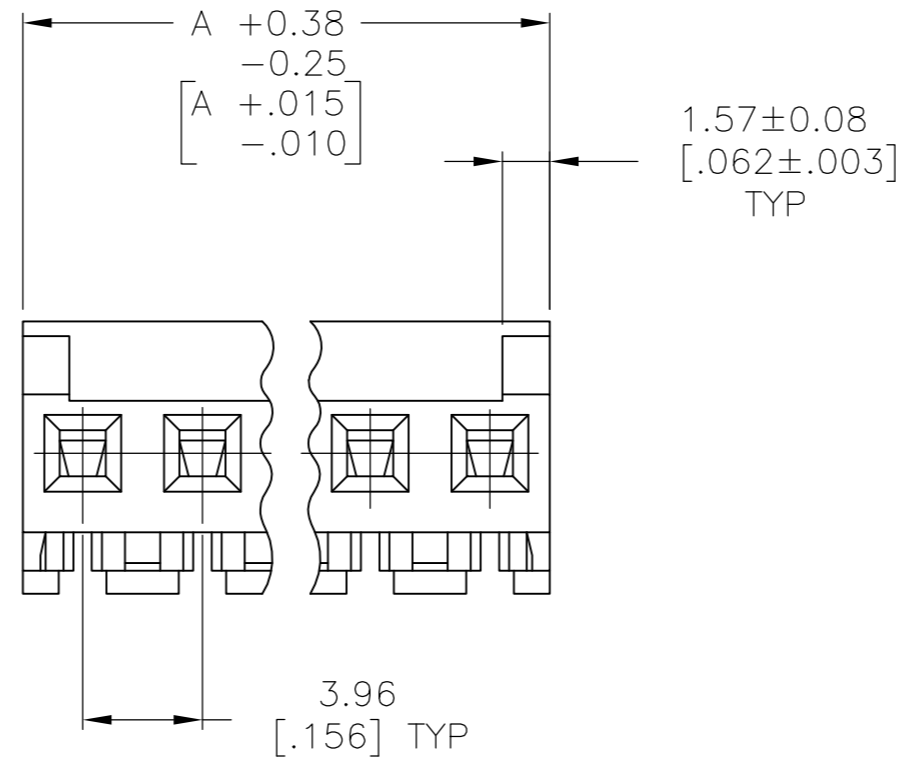
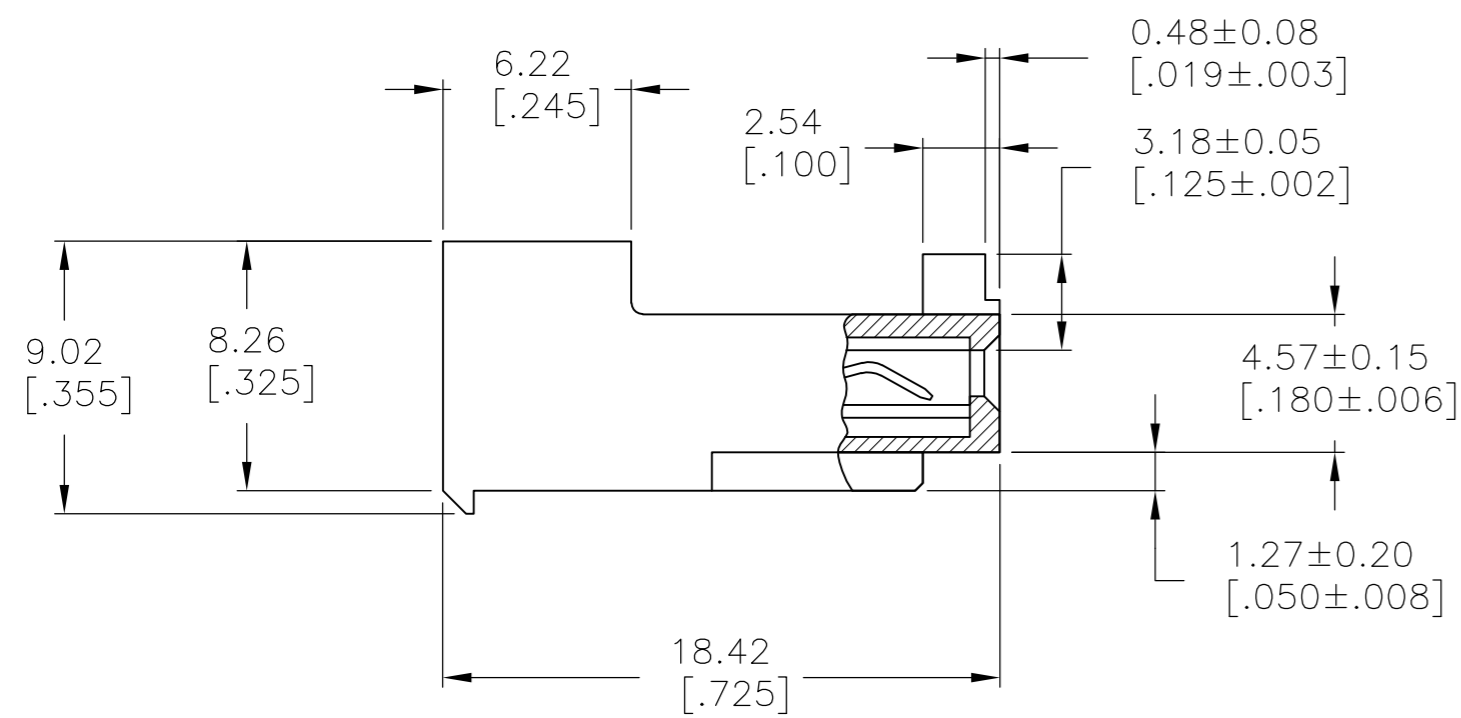
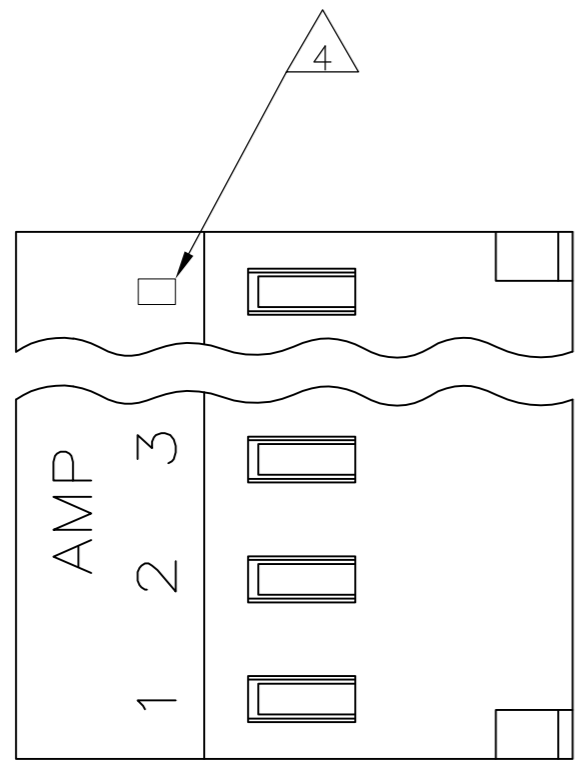

47.55 [1.872]	12	4-644566-2
43.59 [1.716]	11	4-644566-1
39.62 [1.560]	10	4-644566-0
35.66 [1.404]	9	3-644566-9
31.70 [1.248]	8	3-644566-8
27.74 [1.092]	7	3-644566-7
23.77 [.936]	6	3-644566-6
19.81 [.780]	5	3-644566-5
15.85 [.624]	4	3-644566-4
11.89 [.468]	3	3-644566-3
7.92 [.312]	2	3-644566-2
47.55 [1.872]	12	<del>1-644566-2</del>
43.59 [1.716]	11	<del>1-644566-1</del>
39.62 [1.560]	10	<del>1-644566-0</del>
35.66 [1.404]	9	<del>644566-9</del>
31.70 [1.248]	8	<del>644566-8</del>
27.74 [1.092]	7	<del>644566-7</del>
23.77 [.936]	6	644566-6
19.81 [.780]	5	<del>644566-5</del>
15.85 [.624]	4	<del>644566-4</del>
11.89 [.468]	3	<del>644566-3</del>
7.92 [.312]	2	<del>644566-2</del>
DIM A		NO. OF CIRCUITS
		PART NO.

7 SUPERSEDED

7 SUPERSEDED

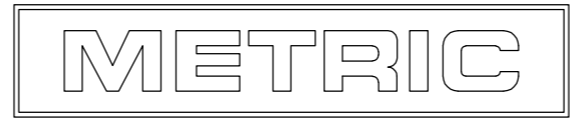

THIS DRAWING IS A CONTROLLED DOCUMENT.

DWN	27JUN91	Tyco Electronics Corporation Harrisburg, Pa 17105-3608
CHK	27JUN91	
APVD	27JUN91	
PRODUCT SPEC		
DIMENSIONS: mm [INCHES] TOLERANCES UNLESS OTHERWISE SPECIFIED: 0 PLC ± - 1 PLC ± - 2 PLC ± - 3 PLC ± - 4 PLC ± - ANGLES ± -		NAME: MTA 156 CONNECTOR ASSEMBLY, 22 AWG, UL94V-0, SPECIAL
MATERIAL	FINISH	SIZE: A2 CAGE CODE: 00779 DRAWING NO: C=644566 RESTRICTED TO: -
CUSTOMER DRAWING		SCALE: 4:1 SHEET: 1 OF 1 REV: B1